

## Eagle AXS Transmission Derailleur

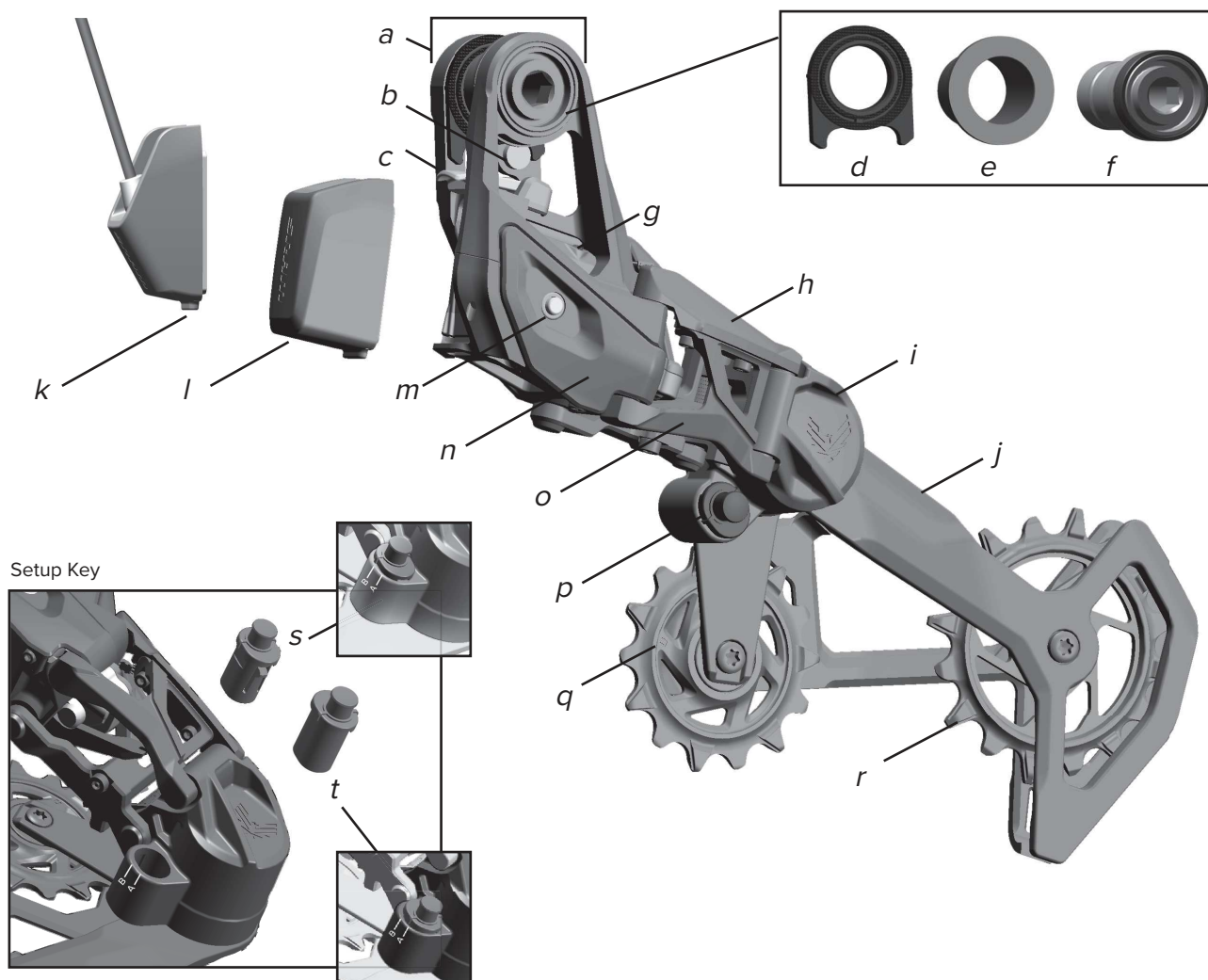

- a. Full Mount
- b. Knurled Ring Stop
- c. Battery Latch
- d. Knurled Ring
- e. Bushing Frame Insert
- f. Mount Bolt
- g. LED Indicator

- h. Upper Parallelogram\*
- i. P-Knuckle
- j. Cage and Damper Assembly
- k. SRAM Extension Cord
- l. SRAM Battery
- m. AXS Button (Pairing, Battery Status)
- n. Skid Plate\*

- o. Lower Parallelogram\*
- p. Setup Key (see insert)
- q. Upper Pulley
- r. Lower Pulley
- s. Setup Key Position B
- t. Setup Key Position A

XXSL Eagle AXS Transmission derailleur shown; product appearance may vary.

\*Replaceable part, see spare part catalog.